

REVISION HISTORY			
REV	DESCRIPTION	DATE	APPROVED

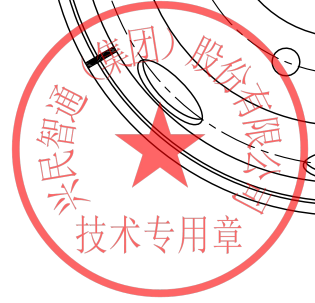
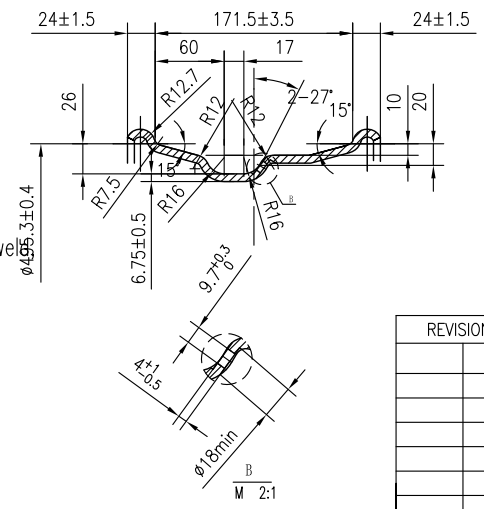
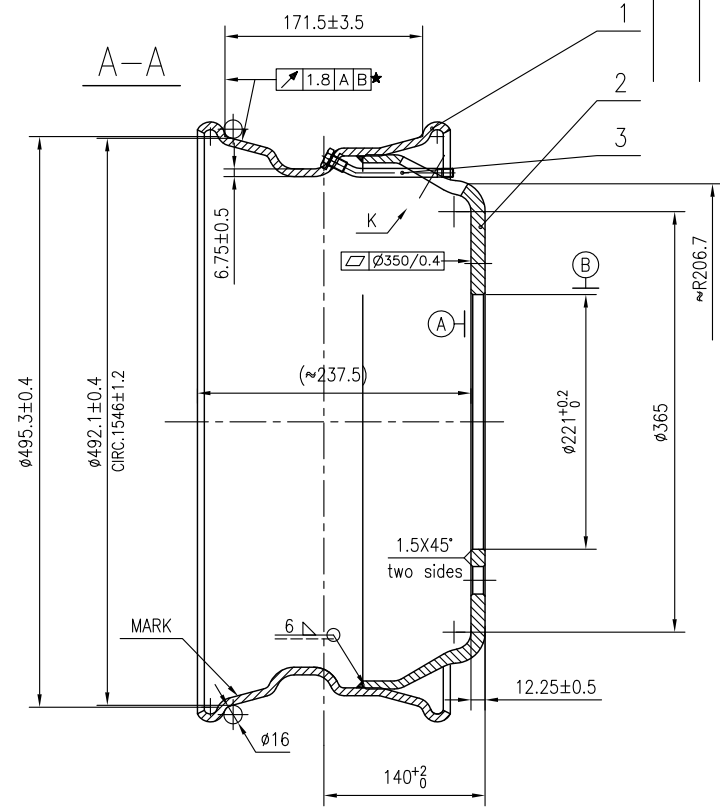
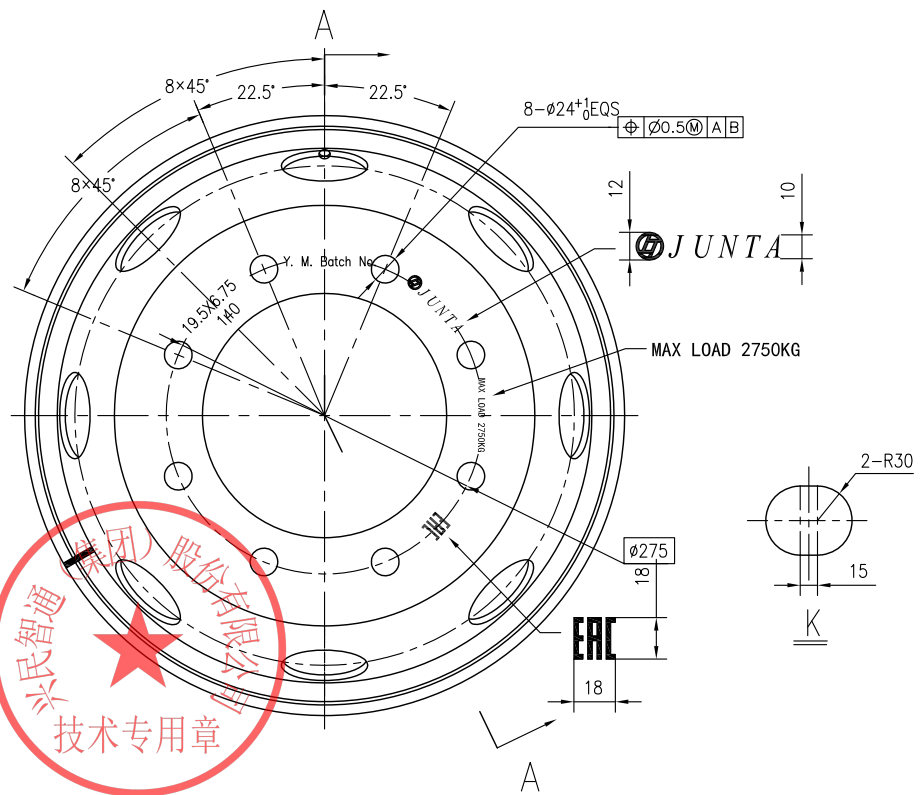

Technology Condition

- Rim profile according to TRA.
- Paint conforms to TQ4 QC/T484—using an electrostatic Epoxy primer coat top coat with silver color;
- Weld firmness, welding line uniformity. Don't allow to have empty weld off weld, not weld fully and other weld defects.
- Valve hole and flange area are clean that no burr.
- Dynamic imbalance quantity is not more than 2000g.cm.
- Stamp: 19.5X6.75 Year Month Batch No. shift No.
- Load: 2750Kg

Test standard: SAE J267
 Test load: cornering: 14494N.m minimum cycle times: 40,000
 radial: 4400Kg minimum cycle times: 1,000,000

No.	Name	Drawing No	Quantity	Material	Remark
3	valve	V3-20-6	1		
2	disc	LT9202-02	1	SW400 ø12.25	
1	rim	LT9202-01	1	BG420CL ø6.75	

REVISION LIST		Name	WHEEL ASSEMBLE			
REVISION	DATE	Stamp	Revised file name	Signature	Date	Remark
		Design		Standize		Type 19.5x6.75 Marker Quantity Weight Scale
		Revised		Approval		Offset (P=140) 1 33.9Kg 1:4.5
		Audit				
		Craft		Date	04.02.2019	Tire Kingmin Intelligent Transportation Systems (Group) CO.,LTD